

Plotted By:Abilad, Emmanuel Sheet:Mill Creek Pompano Layout(C-301) CROSS SECTIONS September 09, 2025 05:37:10pm K:\FTL\_Civil\043 jobs\043175014 Mill Creek Pompano\Design\CADD\Plans\Sheets\C-XSEC.dwg  
This document, together with the concepts and designs presented herein, as an instrument of service, is intended only for the specific purpose and client for which it was prepared. Reuse of and improper reliance on this document without written authorization and adaptation by Kintley-Horn and Associates, Inc. shall be without liability to Kintley-Horn and Associates, Inc.

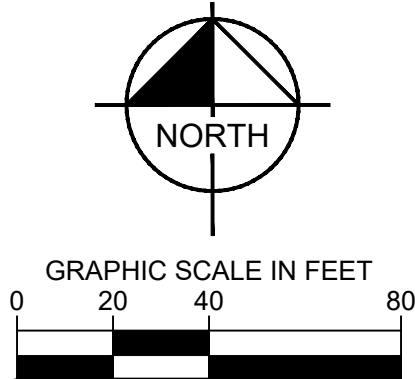

LEGEND

- 1 TYPE 'D' CURB
- 2 VALLEY GUTTER
- 3 TYPE 'F' CURB AND GUTTER
- 4 CONCRETE SIDEWALK (PEDESTRIAN RATED AREAS)
  - 4" THICK TYPE 1 PORTLAND CEMENT CONCRETE
  - COMPRESSIVE STRENGTH AT 28 DAYS, 3000 PSI
  - BRUSH FINISH
- 5 1.5" TYPE SP-9.5 ASPHALTIC CONCRETE
- 6 8" LIMEROCK BASE COMPACTED IN 2 LIFTS TO AT LEAST 98% WITH A MINIMUM LBR OF 100
- 7 8" SUBGRADE COMPACTED IN 2 LIFTS TO AT LEAST 95% WITH A MINIMUM LBR OF 40
- 8 6" PAVERS DRIVEWAY (HEAVY DUTY)
- 9 6" LIMEROCK BASE COMPACTED IN 2 LIFTS TO AT LEAST 98% WITH A MINIMUM LBR OF 100
- 10 6" SUBGRADE COMPACTED IN 2 LIFTS TO AT LEAST 95% WITH A MINIMUM LBR OF 40
- 11 12" THICK SUBGRADE COMPACTED AND STABILIZED WITH MINIMUM DESIGN LBR OF 40 COMPACTED TO AT LEAST 98% MODIFIED PROCTOR MAXIMUM DRY DENSITY (ASHTO T-180)
- 12 6" DECORATIVE PAVER (REFER TO LANDSCAPE PLANS FOR DETAILS)
- 13 2" PARKING OVERHANG
- 14 HARDSCAPE PAVERS (SEE LANDSCAPE PLANS FOR DETAILS)

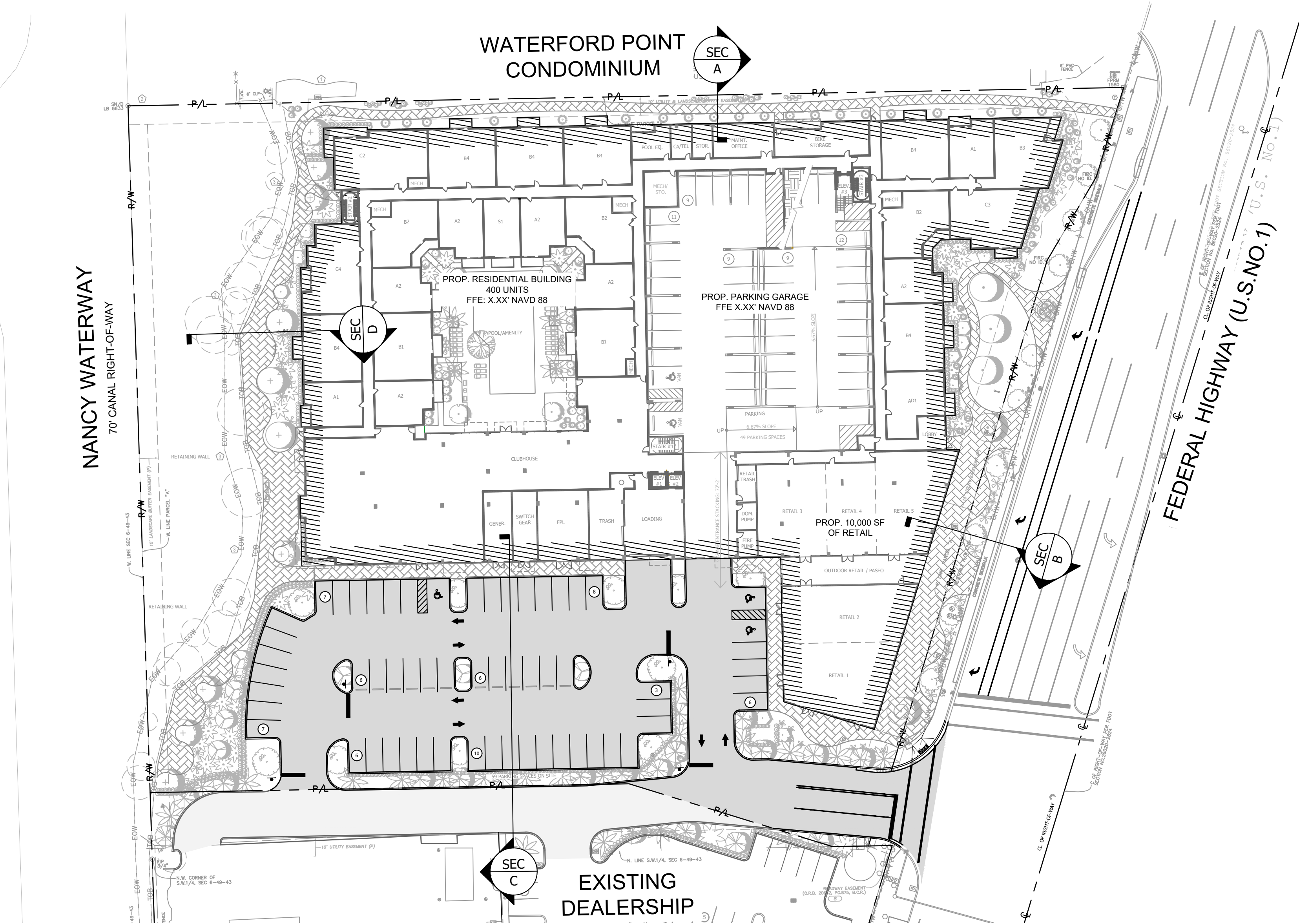
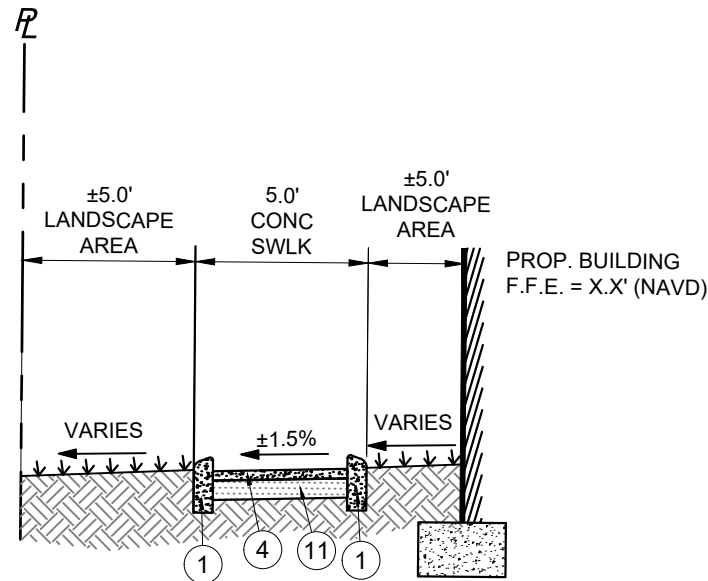

SECTION A

SCALE: 1" = 10'

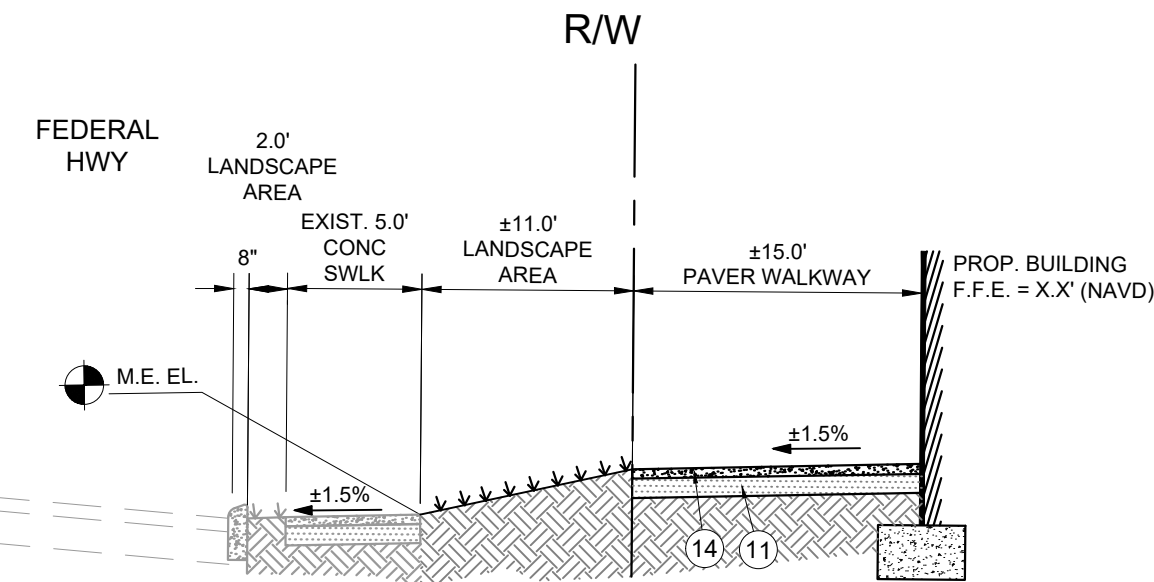

SECTION B

SCALE: 1" = 10'

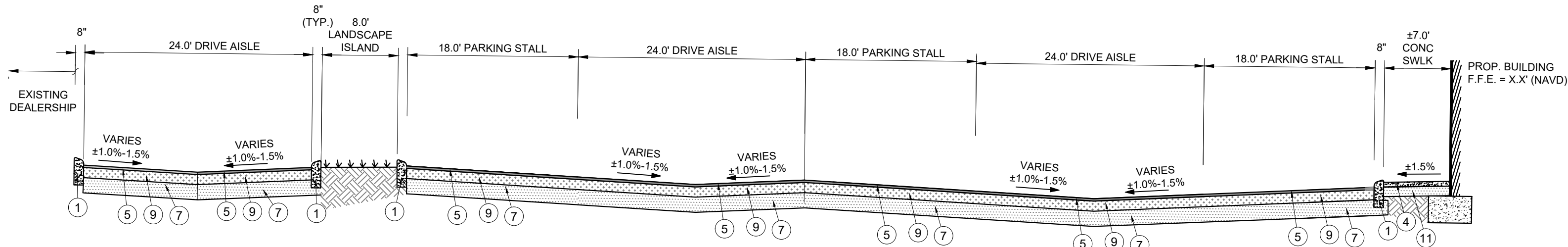

SECTION C

SCALE: 1" = 10'

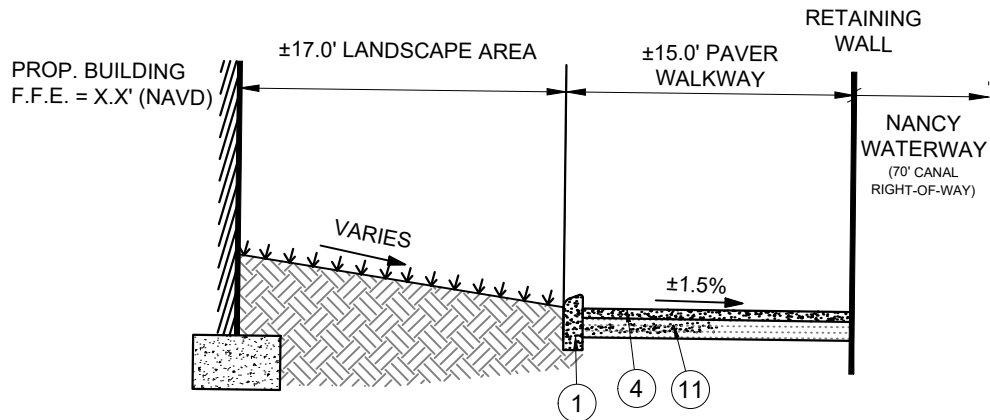

SECTION D

SCALE: 1" = 10'

DRC

PZ25-12000028

10/15/2025

Kimley»Horn

© 2025 KIMLEY-HORN AND ASSOCIATES, INC.  
8201 PETERS ROAD, SUITE 2200, PLANTATION, FL 33324  
PHONE: 954-535-5100 FAX: 954-739-2247  
WWW.KIMLEY-HORN.COM REGISTRY No. 35106

LICENSED PROFESSIONAL

KHA PROJECT  
043175014

DATE  
9/4/2025

SCALE AS SHOWN  
DESIGNED BY GVF

DRAWN BY EA

CHECKED BY GVF

DATE:

CROSS SECTIONS

MODERA POMPANO BEACH

PREPARED FOR

MCRT INVESTMENTS LLC

POMPANO BEACH FLORIDA

SHEET NUMBER  
C-301

REVISIONS

DATE

BY